

Bramcote Park

A creative team to work with the local community

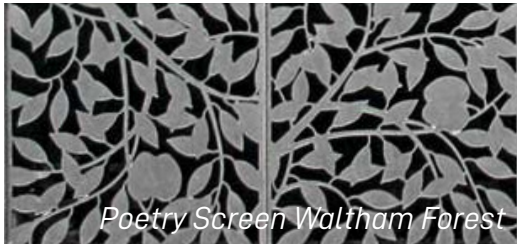

John Puttick Associates

We are architects designing creative public places, re-imagining heritage and building with communities

John Puttick Associates is a London-based architectural studio specialising in civic and public sector projects and working throughout the UK. The studio was founded in 2014 with a competition-winning entry for the refurbishment of Preston's Brutalist bus station, which reopened to critical acclaim, winning the 2021 World Monument Fund Modernism Prize.

The studio - which is intentionally small, responsive and agile - is currently leading the retrofit of a Grade II listed maltings in Grimsby town centre into Horizon Youth Zone, and the extension of a Grade II* Listed Charles Barry-designed church in Brighton. A new youth centre for charity OnSide was completed in Croydon, south London in 2019. Balancing responsive design with a rigorous approach to construction, the practice prides itself on delivering good value to clients as well as producing highly functional buildings that serve the needs and expectations of those who will use them for years to come.

BBUK

BBUK is an award-winning landscape practice led by Harriet Bourne

From its inception in 2002 the practice has taken on a wide range of projects ranging from Streetscape Design Guidance, Public Parks and Open Spaces through to private gardens for individual and commercial clients.

BBUK tailor each project to suit both the existing landscape and the client's vision. Our practice design philosophy is based on a belief that as designers we should not impose our personalities on a site, but through immaculate detailing, seek to discover and reveal the essential characteristics of each place, be this through the ecology, landform, vegetation or urban context.

This ethos has resulted in a portfolio of sensitive and beautifully crafted projects that work on many levels, and always seek to find the extraordinary in the ordinary. BBUK are a chartered landscape practice registered with the Landscape Institute.

Heather Burrell

Heather Burrell is an artist, offering fine art and metalwork intended for public spaces

Art is not just for galleries and museums. Art can bring meaning and a sense of place to any public area, transforming that space and becoming a symbolic point of reference in the minds of all.

As an artist, Heather believes in the simple definition that art is an expression of creative skill and imagination. However, it's the meaning that it has to the viewer which is most important.

With over three decades of experience producing art in the public domain, Heather has established a proven track record of managing budgets and deadlines to deliver high quality, site-specific sculpture and functional artwork using the versatile medium of steel, including a number of projects in Southwark. Community engagement has often been the starting point for commissions. This inspires the work through creative collaboration.

Celebrating the community and its history

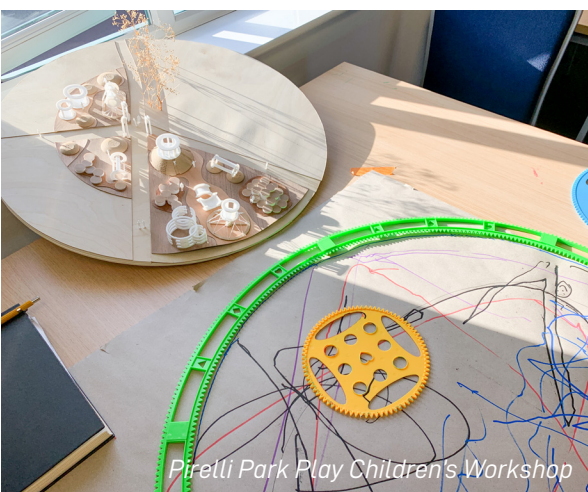

Our team specialise in designing creative public places and enjoy working closely with local communities to improve their everyday buildings and spaces. We are very enthusiastic to be involved with Bramcote Park as it presents the opportunity to transform the space for the whole community.

We will work closely with stakeholders and community groups to understand the ambitions of all involved. We have run a number of creative workshops for previous projects that have engaged local residents of all ages including creative events for children and young people. We will bring this approach to a process of co-design with the community of Bramcote Park. We also propose to work with groups from local schools, involving them in site tours and engaging them in the design process.

The history of the area will be woven into the design, rooting Bramcote Park in its place. Rather than start with preconceived ideas we will talk to local residents about their memories of the neighbourhood and what is important to them.

Safety is always a central concern in the design of public spaces and we will also work closely with residents to understand the local area and specific concerns. Lighting, materials and structures will be designed to enhance safety, be robust and sustainable - and minimise the use of precious resources.

Please scan this QR code to submit feedback on the proposed competition entry



Bramcote Park

Sketch ideas to begin the design conversation

Bramcote Park is a public place that is used by the community as part of their everyday lives. The project to revitalise the park should bring joy, creativity and variety - providing a richness that can be discovered over time and changes through the seasons. Shown here are our initial sketch ideas - which we hope to develop with the full involvement of the community.

The park is re-imagined as a welcome community space with activities for people of all ages. Currently divided by Verney Road, it will be united by a broad and colourful crossing. Bramcote Park will then be conceived as a whole, sharing design concepts, routes and materials. We have envisaged the park as a **patchwork** - a rich composition of diverse activities, materials and spaces that bring the park together. Rather than a separation of 'play' and 'nature' spaces, we suggest a variety of ecological and play elements be drawn throughout the whole design - creating a range of areas that are enjoyable and surprising. Sculptural features - constructed by re-using the existing railings and metalwork - emphasise continuity across Verney Road and signal to drivers to slow (further emphasised by road narrowing).

Our design focuses on both joy and health - giving opportunities for exercise and sustainable travel with jogging encouraged through a running track and cycling through creative cycle parking. Play terraces consist of social areas and activities for adults and young people such as table tennis, exercise equipment and seating. The basketball court will be resurfaced if the budget allows. For children, timber play structures are scattered along the play trail and evoke the neighbourhood's industrial past, encouraging open-ended creative play. A large events space and picnic lawn provide flexibility.

All existing trees will be retained. A planted buffer is proposed for the north-east edge of the park, providing privacy to the houses but with links through. A wildflower meadow continues along the residential boundary to the south, enhancing biodiversity. Water conservation will be carefully considered in the design. The park will become a permeable 'sponge park' with all rainwater captured and transferred to the ground through permeable surfaces. Areas of fluctuating natural pond will add to the habitats and form part of the play route for children.



Forming The Patchwork

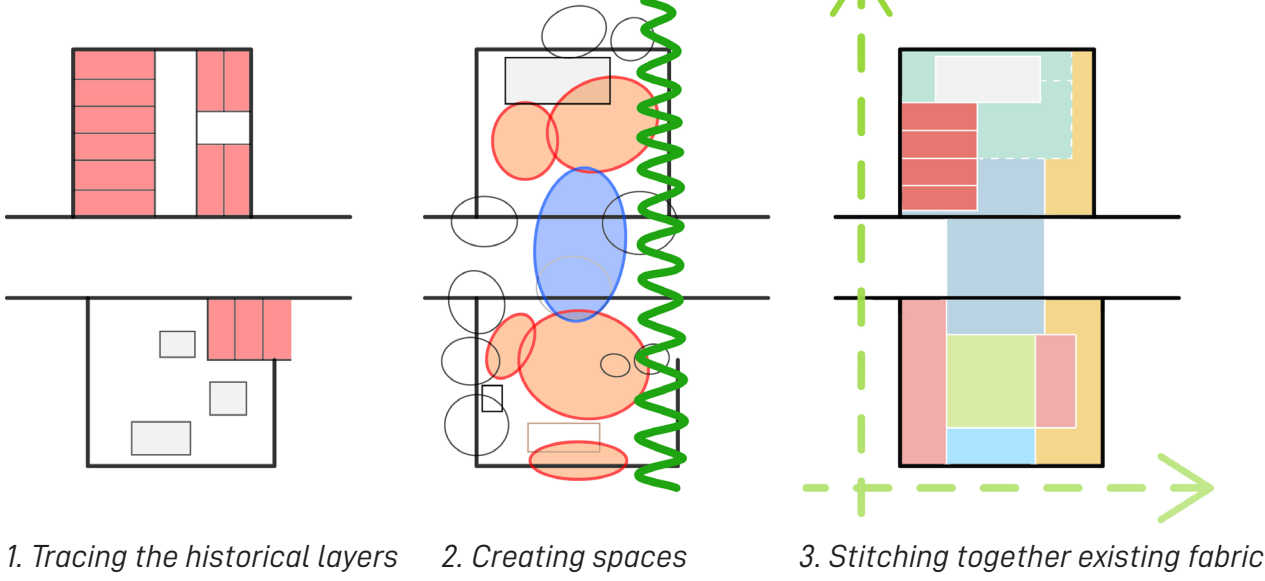

Aerial View of Bramcote Park

- KEY**
- Flexible Spaces**
- 1. Event Space/ Seating Area
 - 2. Picnic Area/ Lawn
- Activity Areas**
- 3. Natural Play Trail
 - 4. Play Terraces
 - 5. Basketball Court
 - 6. Running Track
- Planting Zones**
- 7. Planted Buffer
 - 8. Wildflower Meadow
- Natural Water Basins**
- 9. Fluctuating Water Basin
 - 10. Swale with Planting



Bramcote Park: view along Verney Road



Bramcote Park: view of play trail



Bramcote Park: view of play terraces



Please scan this QR code to submit feedback on the proposed competition entry

